

## DCP-9040CN Specifications

GENERAL	
<b>Technology</b>	Electrophotographic (Single-pass)
<b>Simultaneous Operation</b>	Print/Copy, Print/Scan
PRINT	
<b>Print Speed (Mono/Colour)</b>	Up to 20ppm / 21ppm (A4/Letter)
<b>Print Resolution</b>	600 x 600 dpi, 2,400 dpi (2,400 x 600) quality
<b>First Print Out Time (Mono/Colour)</b>	Less than 16 secs / Less than 17 secs (From Ready Mode, Standard Tray)
<b>Emulation</b>	PCL®6 / BR-Script 3
COPY	
<b>Copy Speed</b>	Up to 16 cpm / 17 cpm (A4/Letter)
<b>Copy Resolution</b>	Max. 1,200 x 600 dpi
<b>First Copy Out Time (Mono/Colour)</b>	Less than 21 sec s / Less than 23 secs
<b>Multi Copy (Stack)</b>	Up to 99 sheets
<b>Multi Copy (Sort)</b>	Yes
<b>Enlargement/Reduction Ratio</b>	25% - 400% in 1% increments
<b>N in 1</b>	Yes
SCAN	
<b>Scan Resolution (Mono/Colour)</b>	Max. 1,200 x 2400 dpi (Optical) Max. 19,200 x 19,200 dpi (Enhanced)
<b>Grey Scale</b>	256
<b>Colour Depth</b>	48-bit / 24-bit
<b>Document Size</b>	Up to A4/Letter (From Glass) / Up to Legal (ADF)
<b>'Scan' Key</b>	Scan to Email, Image, OCR, File, FTP
CONTROLLER	
<b>Processor</b>	300MHz
<b>Memory Capacity</b>	64MB (Expandable up to 576MB, using industry standard 1 x SO-DIMM (144 PIN) slot)
<b>Interface</b>	Hi-Speed USB 2.0
<b>Network (Built-in)</b>	10/100 Base-TX
<b>Network Management Tools</b>	BRAdmin Professional – Brother original Windows® utility for printer and print server management Web BRAdmin – Server based management utility / Windows® IIS (4.0/5.0) mode only Web Based Management – Printer and print server management through web browser BRAdmin Light – Printer and print server management operates under Windows® and Mac OS® X 10.2.4 or greater
<b>Network Security Protocols</b>	SSL (Secure Socket Layer) TCP/IP (IPv4) ARP, RARP, BOOTP, DHCP, APIPA(Auto IP), WINS, NetBIOS name resolution, DNS Resolver, mDNS, LPR/LPD, Custom RawPort/Port 9100, IPP, IPPS, FTP Server, SSL/TLS, POP before SMTP, SMTP-AUTH, TELNET, SNMPv1, HTTP/HTTPS server, TFTP client and server, SMTP Client, APOP, LLTD responder, RAW Port (PC Scanner), FTP Client TCP/IP (IPv6) NDP, RA, DNS, mDNS, LPR/LPD, Custom Raw Port/Port 9100, IPP, IPPS, FTP Server, SSL/TLS, POP before SMTP, SMTP-AUTH, TELNET, SNMPv1, HTTP/HTTPS server, TFTP client and server, SMTP Client, APOP, LLTD responder, RAW Port (PC Scanner)
CONTROL PANEL	
<b>Display</b>	3-colour backlit LCD display with 2-lines, 16 characters
<b>Buttons</b>	[Print] Secure, Job Cancel [Copy] Options, Enlarge Reduce [Scan] One-touch scan key
PAPER HANDLING	
<b>Paper Handling Size</b>	Standard Paper Tray – A4, Letter, JISB5, ISOB5, A5, ISOB6, A6, Executive, Legal, Folio Multi-Purpose Tray – Width 69.8mm to 216mm, Length 116mm to 406.4mm
<b>Paper Input Capacity</b>	Standard Paper Tray - 250 sheets (plain) Multi-Purpose Tray - 50 sheets (plain) / 3 sheets (envelope)
<b>Paper Output Capacity</b>	150 sheet (face down)
MEDIA SPECIFICATIONS	
<b>Media Types</b>	Standard Paper Tray – Plain, Recycled Paper Multi-Purpose Tray – Plain, Thick Paper, and Recycled Paper, Bond, Label, Postcard, Envelope
<b>Media Weights</b>	Standard Paper Tray – 60 to 105g/m2 (16 to 28lb) Multi-Purpose Tray – 60 to 163g/m2 (16 to 43lb)
<b>Media Sizes</b>	Standard Paper Tray – A4, Letter, JISB5, ISOB5, A5, ISOB6, A6, Executive, Legal, Folio Multi-Purpose Tray – Width 69.9mm to 215.9mm, Length 116mm to 406.4mm
SOFTWARE	
<b>Printer Driver Support</b>	Host-based for Windows® 2000 Professional, XP Home Edition, XP Professional (XP Professional & x64 Edition), Windows Vista™, Windows Server® 2003 (32 bit & x64 Edition). Macintosh printer driver for Mac OS® X 10.2.4 or greater Linux printer driver for CUPS & LPD/LPRing printing system (x86 & x64 environment)
<b>Printer Driver Features</b>	N-up Printing – Compress up to 2, 4, 9, 16 or 25 pages onto one single sheet Poster Printing – Enlarge an image to print on 2x2, 3x3, 4x4 or 5x5 onto a single sheet Watermark Printing Booklet Printing – Manual duplex option available Secure Print
<b>Utilities</b>	Colour restriction & colour control tools from printer driver Driver Deployment Wizard – Guides you through the steps of installing a Brother network printer on a networked Windows® PC
<b>Web Download Utilities</b>	<a href="http://solutions.brother.com">http://solutions.brother.com</a> See above list of Network Management Tools
DIMENSIONS/WEIGHT	
<b>Dimensions</b>	432(W) x 487 (D) x 482(H) mm
<b>Weight</b>	Approx. 32.8kg
OTHERS	
<b>Power Consumption</b>	Copying - Average 495W Standby - Average 95W Sleep - Average 28W
<b>Noise Level</b>	Printing Mode: Less than 54.5 dBA Standby Mode: Less than 30dBA
<b>Ecology</b>	Power Save & Toner Save modes 500 to 3,000 pages

<sup>1</sup> Brother #1 Chart at standard resolution on A4 size paper.  
<sup>2</sup> ITU-T Test Page at standard resolution on A4 size paper.

### Minimum System Requirements

Computer	Platform & Operating System	Interface	Minimum Processor	Recommended RAM	Required Hard Disk Space
Windows®	Windows® 2000 Professional	USB, Ethernet	Intel® Pentium® or AMD Equivalent	128 MB	50 MB
	Windows® XP Home, Windows® XP Professional, Windows Vista™			256 MB	
	Windows Server® 2003	Ethernet	Intel® Pentium® 4 64-bit CPU or AMD Equivalent	1 GB	
	Windows® XP Professional x64 Edition	USB, Ethernet	Intel® Pentium® III or AMD Equivalent	512 MB	
	Windows Server® 2003 X64 Edition	Ethernet	AMD Opteron™, AMD Athlon™ 64, Intel® Xeon® with Intel® EM64T, Intel® Pentium® 4 with Intel® EM64T or AMD Equivalent	384 MB	
Macintosh	Mac OS® X 10.2.4 or greater	USB <sup>1</sup> , Ethernet	PowerPC G4/G5, Intel® Core™ Solo/Duo, PowerPC G3 350MHz	160 MB	50 MB



For the latest driver updates, visit [www.brother.com](http://www.brother.com).  
All trademarks, brand and product names are property of their respective companies.

Microsoft, Windows, the Windows logo and Windows Vista are either registered trademarks or trademarks of Microsoft Corporation in the United States and/or other countries.

### Consumables



Achieve better quality prints, greater yields, optimum printer performance and more importantly, protect your machine from damages by using genuine Brother consumables<sup>2</sup>.

Supplies	Model No.	Page Yield <sup>3</sup> (Approx.)
Standard Toner Black	TN-150BK	2,500 pages
Standard Toner Colour (C,M,Y)	TN-150C, TN-150M, TN-150Y	1,500 pages
High Yield Toner Black	TN-155BK	5,000 pages
High Yield Toner Colour (C,M,Y)	TN-155C, TN-155M, TN-155Y	4,000 pages
Drum	DR-150CL	17,000 pages (one page per job)
Belt Unit	BU-100CL	50,000 pages
Optional Lower Tray <sup>4</sup>	LT-100CL	500 pages (paper capacity)

<sup>1</sup> Third party USB ports are not supported.  
<sup>2</sup> As a precaution, please note that your machine warranty may not cover any damages arising from the use of non-genuine Brother consumables.  
<sup>3</sup> Based on A4 plain paper printing at 5% coverage.

Contact:

Brother International Corporation, Nagoya Japan

All specifications correct at time of printing. Brother is a registered trademark of Brother Industries Ltd. Brand product names are registered trademarks of their respective companies.

[www.brother.com](http://www.brother.com)

**brother** At your side.

At your side.  
**brother**

## HIGH LEVEL VERSATILITY to Compliment Your Business Needs



## DCP-9040CN

Network business colour laser printer

**Redefining Business Colour Printing**

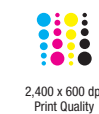

# Print. Copy. Scan.

## High Level Versatility to Compliment Your Business Needs

The new Brother DCP-9040CN printer is a versatile performer built for the business environment. Perfectly poised to handle multiple tasks, it offers printing, copying, and scanning capabilities all in one compact machine. The DCP-9040CN also offers network connectivity, allowing workgroups to share print resources for increased cost-efficiency.



Up to 20ppm  
(Colour & Monochrome)



2,400 x 600 dpi  
Print Quality

### High-Speed Printing with Brilliant Colour Quality

The DCP-9040CN gives you excellent print quality of 2400 x 600 dpi at up to 20 A4 pages per minute (ppm). With high levels of contrast and clarity, your documents are guaranteed to leave a lasting impression on your business associates.



Cost Effectiveness

### Cost Effectiveness

Brother provides separate CMYK toners and a drum that reduces your total cost of ownership. Monochrome printing can still be done when any of the Cyan, Magenta or Yellow toner cartridges runs low.



Network Ready

### Easy Network Integration

The DCP-9040CN is equipped with an Ethernet port and an integrated 10/100 Base-TX network Card for seamless integration with your existing IT infrastructure. Connecting the printer to a LAN environment lets you share the printing function with your work team.

### Effortless Management with the Embedded Web Server

Manage your printer using the Embedded Web Server (EWS), which can be accessed from any web browser. EWS has the following features:

- Auto-detect all Brother printers on the local LAN.
- Dynamically change printer and print server settings (including paper settings, power save settings).
- Custom email notifications to alert when toner levels are running low or when print job errors require rectification.



Lock Colour Usage

### Lock Colour Usage

The Lock Colour Usage feature in the DCP-9040CN allows administrators to prevent unauthorized colour printing.

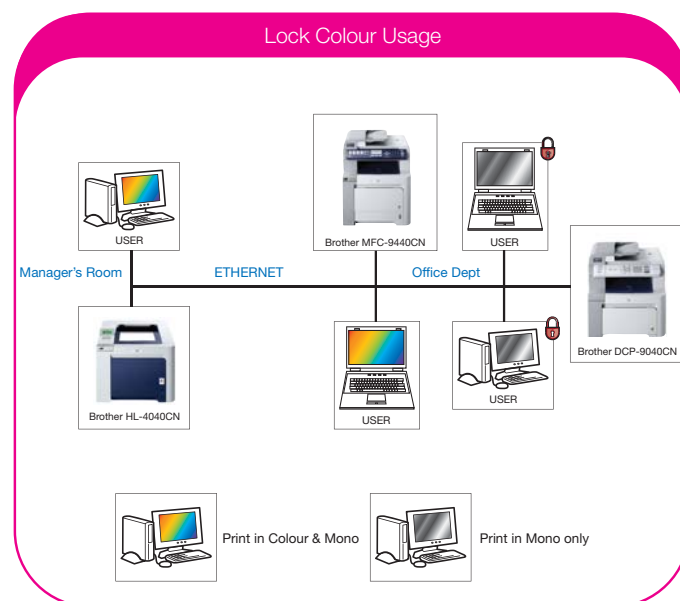

### Enhanced Usability

Designed for a high ease of use, the DCP-9040CN has an intuitive control panel conveniently placed for easy operation of scan and copy functions.

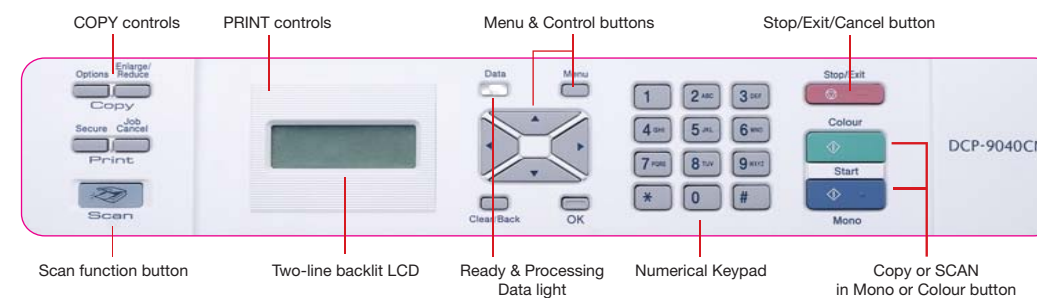

### Copy/Scan Features



Copy

### Full Colour Copying Brilliance

Expect brilliant full colour copies with the MFC-9040CN at 16 A4 copies per minute (cpm) and at a copy resolution of max. 1200 x 600 dpi. With a first copy output time of less than 21 seconds\*, copying of A4 size documents is fast and made easier with the 35-sheet automated document feeder. Stacking and sorting features also add to your convenience by automatically collating your printed documents.

\*Monochrome copy, FCOT of full-colour copy is less than 23 secs.



Scan

### High Functionality Scanning

The DCP-9040CN's flat-bed design and one-touch 'Scan' button makes it easy to obtain high-quality scans of up to 1200 x 2400 dpi (Optical/Glass). It also provides the following scanning features:

- Scan to File** saves your scanned document as a specific file type to a pre-defined folder.
- Scan to Image** loads your scanned image to the selected imaging or photo application so you can save, print or edit the original image.
- Scan to E-Mail** lets you send email with the scanned image as an attachment.
- Scan to FTP\*** allows you to scan and upload your document to a designated FTP folder.
- Scan to OCR** automatically detects text documents and scans it into an editable rich text format.

\*File Transfer Protocol - Up to 10 FTP sites can be preset so users can select the pre-configured profile easy via the DCP's keypad.



Toner Save Function

### Toner Save Function

You can select Toner Save Mode for printing draft documents, so as to reduce toner usage for non-important printouts.



Sleep Function

### Sleep Function

The intelligent sleep function analyses printing frequency and time to determine the most appropriate time to activate sleep mode, saving you time and power.

### Full Frontal Operation

The DCP-9040CN is designed for full frontal operation. This means that changing of consumables and loading of paper are all done through the front of the printer, giving you a greater level of convenience.



Paper Input Trays



Toners & Drum

**DCP - 9040CN**  
Network business colour laser printer

